

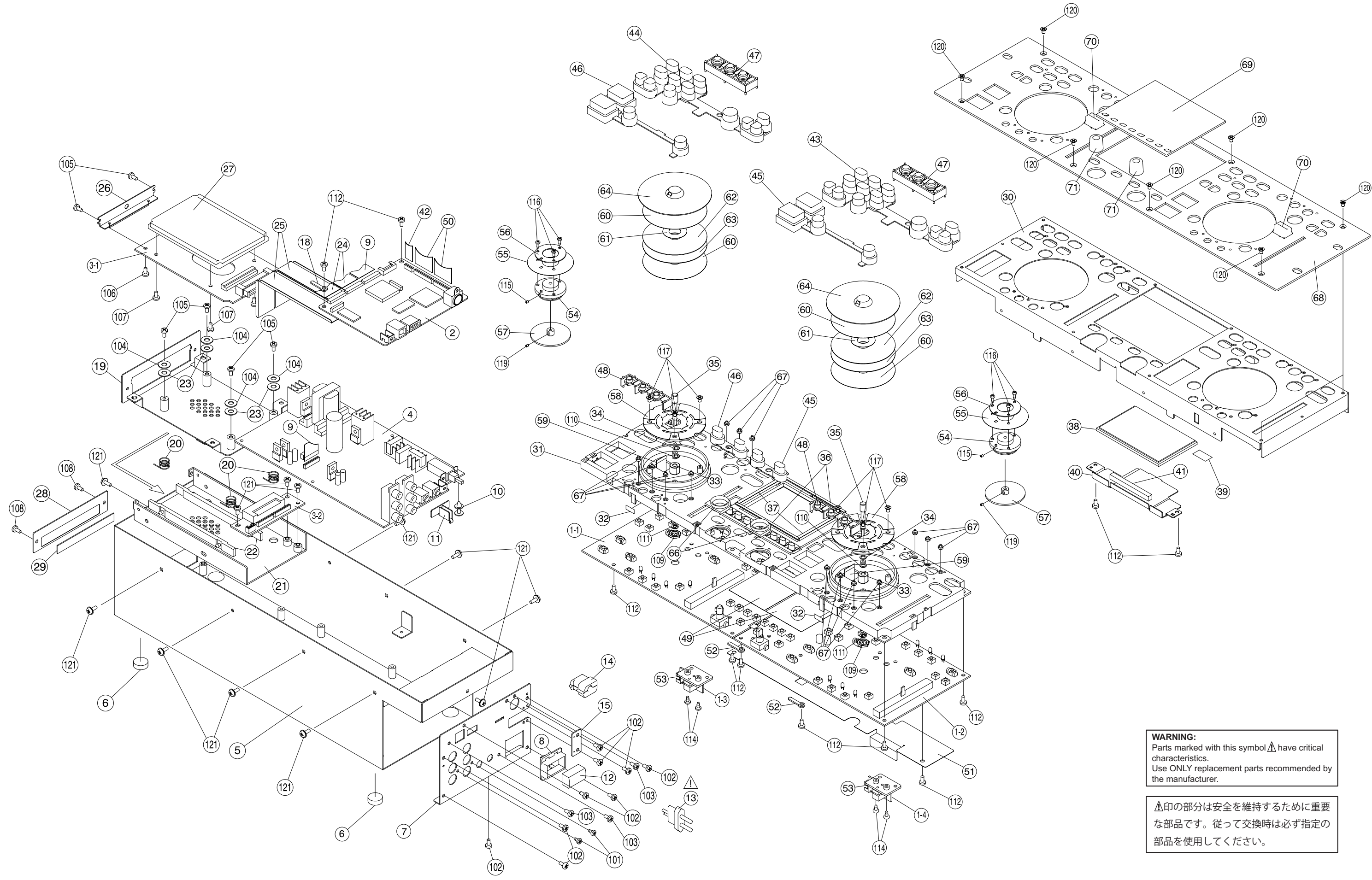

EXPLODED VIEW



WARNING:
 Parts marked with this symbol  have critical characteristics.
 Use **ONLY** replacement parts recommended by the manufacturer.

印の部分は安全を維持するために重要な部品です。従って交換時は必ず指定の部品を使用してください。

PARTS LIST OF EXPLODED VIEW

* 本表に記載されている部品は、補修用部品のため製品に使用している部品とは一部、形状、寸法などが異なる場合があります。
 * The parts listed below are for maintenance only, might differ from the parts used in the unit in appearances or dimensions.

* "nsp" 印の部品は常時在庫していませんので供給に長時間を要することがあります。場合によっては、供給をお断りする場合があります。
 * Part indicated with the mark "nsp" are not always in stock and possibly to take a long period of time for supplying, or in some case supplying of part may be refused.

Note: The symbols in the column "Remarks" indicate the following destinations.
 E3 : U.S.A. & Canada model E2 : Europe model

Ref. No.	nsp	Part No.	Part Name	Remarks	Q'ty	New
1		00DGU-3778	PANEL P.W.B UNIT ASSY		1	*
1-1			PANEL UNIT1			
1-2			PANEL UNIT2			
1-3			SENSOR1 UNIT			
1-4			SENSOR2 UNIT			
1-5			DISC1 UNIT			
1-6			DISC2 UNIT			
2		00DGU-3780	MAIN P.W.B UNIT ASSY		1	*
3		00DGU-3781	SLOT P.W.B UNIT ASSY		1	*
3-1			SLOT1 UNIT			
3-2			SLOT2 UNIT			
4		00DGU-3782E2	POWER P.W.B UNIT ASSY (E2)	for E2	1	*
4		00DGU-3782E3	POWER P.W.B UNIT ASSY (E3)	for E3	1	*
5		00D 105 1676 107	CASE ASSY		1	*
6		00D 461 0706 101	FOOT SHEET		4	
7		00D 105 1674 109	REAR PANEL		1	*
8	nsp	00D 146 2433 007	P.SW KNOB GUIDE		1	
9		00D 009 0103 001	18P FFC CABLE		1	*
10	nsp	00M 446 S101 010	SUPPORT		1	
11	nsp	00D 441 2020 001	FADER GUARD		1	*
12		00D 113 1689 001	P.SW KNOB		1	
13		00D 206 2089 106	AC CORD W/CON.E2	for E2	1	
13		00D 206 2155 001	AC CORD W/CON.E3	for E3	1	
14		00D 445 0056 008	CORD BUSH	for E2	1	
14		00D 445 0084 009	CORD BUSH	for E3	1	
15		00D 441 2016 002	BUSH PLATE		1	*
★ 16	nsp	00D 415 0767 079	UL TUBE (16) BK		1	*
★ 17	nsp	00D 445 8004 007	WIRE CLAMPER		1	
18	nsp	00D 445 8028 009	CORD HOLDER		1	
19	nsp	00D 441 2012 103	HDD BRACKET 1		1	*
20	nsp	00D 463 0977 004	SPRING		4	*
21	nsp	00D 441 2013 102	HDD BRACKET 2		1	*
22	nsp	00D 415 1005 002	HDD GUIDE		2	*
23	nsp	00D 461 1280 008	HDD WASHER		4	*
24		00D 009 0290 011	20P FFC(1.0) L=170		2	*
25	nsp	00D 461 1295 006	FFC GUARD		2	*
26	nsp	00D 441 2017 001	HDD BRACKET 3		1	*
27		00D 399 1089 001	HDD(MHW2040AT)		1	*
28		00D 144 3001 005	HDD COVER		1	*
29		00D 461 1281 007	HDD COVER 1 BUFFER		1	*
30	nsp	00D 411 2103 105	MAIN BRACKET		1	*
31	nsp	00D 146 2484 108	INNER PANEL ASSY		1	*
32	nsp	00D 421 0853 108	REFLECTION SHEET		2	*
33		00D 443 1617 107	BEARING		2	*
34		ORD 475 1161 016	WASHER		2	
35		00D 422 0685 104	SHAFT		2	*
36		00D 461 1277 105	LCD BUFFER 1		2	*
37		00D 461 1278 104	LCD BUFFER 2		2	*
38		00D 393 6028 001	LCD MODULE(MD578TT72)		1	*
39		00D 421 0856 008	PROTECT SHEET		1	*
40	nsp	00D 441 2015 003	LCD SHIELD		1	*

Ref. No.	nsp	Part No.	Part Name	Remarks	Q'ty	New
41	nsp	00D 461 1287 108	LCD SHIELD BUFFER		1	*
42		00D 009 0288 007	12P FFC(0.5)230-FNM		1	*
43		00D 113 2084 100	BUTTON A		1	*
44		00D 113 2085 109	BUTTON B		1	*
45		00D 113 2086 108	BUTTON C		1	*
46		00D 113 2087 107	BUTTON D		1	*
47		00D 113 2062 009	BUTTON 3		2	*
48		00D 113 2063 008	BUTTON 4		2	*
49	nsp	00D 461 1294 007	LCD INSULATOR		2	*
50		00D 009 0290 008	23P FFC(1.0) L=250		2	*
51		00D 421 0852 109	PROTECTION SHEET		1	*
52	nsp	ORD 445 0048 003	CORD HOLDER (L76)		2	*
53	nsp	00D 441 2014 004	T. SENSOR BASE		2	*
54		00D 421 0838 013	WHEEL ASSY (2)		2	*
55		00D 421 0836 002	SCALE DISC		2	
56		00D 441 2006 009	DISC FIX PLATE		2	
57		00D 421 0854 000	JOG WEIGHT		2	*
58		00D SPK 563	TOUCH SENSOR UNIT		2	*
59		00D 009 0290 037	11P FFC(1.0) L=60		2	*
60		00D 421 0849 028	SLIP MAT(B)		4	*
61		00D 421 0849 057	SLIP MAT(E)		2	*
62		00D 421 0849 031	SLIP MAT(C)		2	*
63		00D 421 0849 015	SLIP MAT(A)		2	*
64		00D GEN 8321	JOG WHEEL SUB ASSY		2	*
66		00D 143 1264 003	COLOR RING		2	*
67		00D 143 1268 106	LENS 2		16	*
68		00D 144 3000 103	TOP PANEL		1	*
69		00D 143 1267 107	WINDOW		1	*
70		00D 113 2078 103	SLIDE KNOB		2	*
71		00D 112 0982 007	KNOB 1		2	*
★ 72	nsp	00D GEN 8311	R. SHEET E2 SUB ASSY	for E2	1	*
★ 73	nsp	00D GEN 8308	R. SHEET E3 SUB ASSY	for E3	1	*
★ 74	nsp	00D 513 4177 008	C-UL MARK US	for E3	1	*
★ 75	nsp	00D 513 3159 001	FCC/CLASS B CAUTION	for E3	1	
SCREWS & WASHERS						
101		ORD 473 7519 006	2.6X8CBTS(P)-B		2	
102	nsp	ORD 473 7015 018	3X8 CBTS (S)-B		13	
103	nsp	ORD 471 3304 028	3X8 CBS-B		3	
104	nsp	ORD 475 1160 004	WASHER		4	
105	nsp	ORD 471 3303 016	3X6 CBS-Z		17	
106	nsp	ORD 473 7002 005	3X6 CBTS(S)-Z		2	
107		ORD 471 3302 017	3X5 CBS		4	
108		ORD 475 5120 011	3X8 HSHB MFZNB		2	
109		ORD 477 0330 103	8 N-Z		2	*
110	nsp	ORD 475 1187 032	WASHER 7/4.2		2	
111		ORD 476 1003 009	3 E RING		2	
112	nsp	ORD 473 7002 018	3X8 CBTS (S)-Z		12	
113	nsp	ORD 473 7500 015	3X8 CBTS (P)-Z		21	
114		ORD 473 7505 010	2.6X6 CBTS (P)-Z		4	
115		ORD 474 4310 007	2X2.5 BSS		2	
116		ORD 473 7506 019	2X6 CBTS (P)-Z		6	
117		ORD 473 7520 008	2.6X6 CFTS(P)-B		8	
119		ORD 474 4300 017	2.6X3 BSS		2	
120		ORD 471 2801 030	3X5 CFS-B		8	
121		ORD 473 8007 083	3X8 CUP SCREW		10	