

# EXPLODED VIEW

1 2 3 4 5 6 7 8

**WARNING:**  
Parts marked with this symbol  have critical characteristics.  
Use **ONLY** replacement parts recommended by the manufacturer.

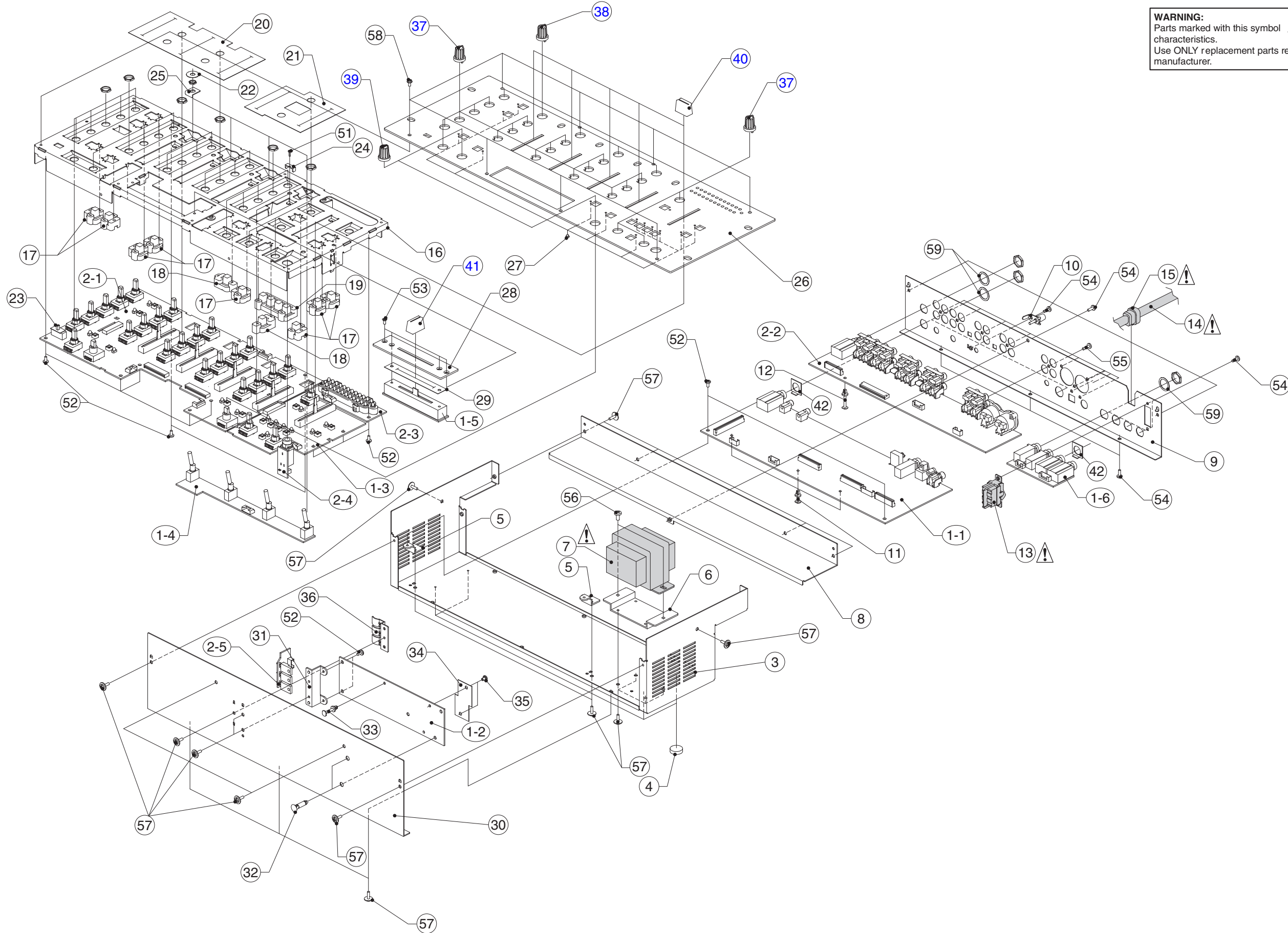

A

B

C

D

E

# PARTS LIST OF EXPLODED VIEW

Note: The symbols in the column "Remarks" indicate the following destinations.  
 E3: U.S.A./Canada model  
 E2: Europe model

Ref. No.	Part No.	Part Name	Remarks	Q'ty	Ref. No.	Part No.	Part Name	Remarks	Q'ty
1	GU-3402	Main P.W.B. unit Ass'y		1	40	113 1920 003	CH fader knob		5
1-1		Main unit			41	113 1921 002	Cross fader knob		1
1-2		Power unit			42	412 4859 007	Earth plate		2
1-3		Panel 2 unit			★ 43	009 0162 026	31P FFC cable	CX311	1
1-4		Line selector unit			★ 44	203 4967 065	3P VH connector cord		1
1-5		Cross fader unit			★ 45	009 0205 035	21P FFC cable	CY211	1
1-6		Zone/effect unit			★ 46	204 2544 014	7P KR-KR ribbon cable	CX071	1
2	GU-3403	Panel I/O P.W.B. unit Ass'y		1	★ 47	009 0105 041	25P FFC cable	CX251,252	2
2-1		Panel 1 unit			★ 48	009 0205 022	19P FFC cable	CX191	1
2-2		Analog I/O unit			△ ★ 71	206 1015 032	Fuse 2.5A	F801, for E2	1
2-3		Display unit			△ ★ 71	206 1039 076	Fuse 2.5A	F801, for E3	1
2-4		H/P jack unit			△ ★ 72	206 1015 058	Fuse 1.6A	F802, for E2	1
2-5		Regulator unit			△ ★ 72	206 1039 050	Fuse 1.6A (T)	F802, for E3	1
3	105 1369 100	Bottom cover		1	★ 73	513 2784 011	Fuse label	for F801, for E2	1
4	461 0706 127	Foot sheet		4	★ 74	513 2784 082	Fuse label (1.6A)	for F802, for E2	1
5	412 4735 008	P.W.B. support		2	★ 75	415 0455 006	UL tube (3)		2
6	412 4736 007	Trans bracket		1	★ 76	445 0033 005	Wire clamp band		5
△ 7	233 6380 007	Power trans. (E2)	for E2	1	★ 77	513 8266 009	Dangerous mark	for E3	1
△ 7	233 6376 008	Power trans. (E3)	for E3	1	★ 78	513 3684 000	Rating sheet (E2)	for E2	1
8	105 1370 018	Rear cover		1	★ 78	513 3684 013	Rating sheet (E3)	for E3	1
9	105 1388 000	Back panel		1	★ 79	513 2303 007	Version label	for E2	1
10	205 1116 006	Terminal Ass'y		1	★ 80	513 2521 009	CE label	for E2	1
11	412 2814 028	Card spacer (L=10)		3	★ 80	513 3599 001	C-UL mark US	for E3	1
12	412 2937 002	Card spacer (L=20)		1	★ 81	513 3253 004	C-TICK label	for E2	1
△ 13	212 4695 001	Power switch		1	★ 81	513 3620 006	FCC/class A caution	for E3	1
△ 14	206 2089 106	AC cord (E2)	for E2	1	★ 82	513 3724 009	Caution label	for E3	1
△ 14	206 2155 001	AC cord (E3)	for E3	1	<b>SCREWS &amp; NUTS</b>				
△ 15	445 0056 008	Cord bush	for E2	1	51	471 3101 014	Screw 2x4 CBS		2
△ 15	445 0084 009	Cord bush	for E3	1	52	473 7002 005	Screw 3x6 CBTS (S)-Z		15
16	441 1946 005	Front sub panel		1	53	471 2303 020	Screw 3x6 CFS-B		4
17	119 0109 001	Rubber key (1-A)		8	54	473 7015 018	Screw 3x8 CBTS (S)-B		9
18	119 0110 100	Rubber key (1-B)		2	55	473 7508 017	Screw 3x10 CBTS (P)-B		10
19	119 0111 002	Rubber key (4)		1	56	473 7004 003	Screw 4x8 CBTS (S)-Z		2
20	122 0235 007	Blind sheet (A)		1	57	473 8007 083	Cup screw 3x8		22
21	122 0236 006	Blind sheet (B)		1	58	471 1832 000	Screw M3 SEMS		8
22	122 0231 001	Blind sheet (TG)		4	59	475 1184 006	12 Washer		7
23	122 0232 000	Blind sheet (SW)		1					
24	412 4738 005	Slide volume bracket		2					
25	412 4837 003	Toggle bracket		4					
26	144 2755 116	Front panel		1					
27	143 1072 004	Lens		14					
28	144 2756 005	Fader panel		1					
29	122 0234 008	Blind sheet (FADER)		1					
30	105 1373 109	Front cover		1					
31	412 4734 009	P.W.B. bracket		1					
32	412 2741 023	P.W.B. holder (H=16)		2					
33	412 2814 060	Card spacer (L=16)		1					
34	415 0863 009	Protect sheet		1					
35	479 0003 025	Push rivet		2					
36	412 4812 015	Spring plate		1					
37	112 0888 004	White Knob (MARU)		22					
38	112 0888 020	Orange Knob (MARU)		5					
39	112 0889 003	Assign knob (MARU)		2					